

Location map of waste reception facilities

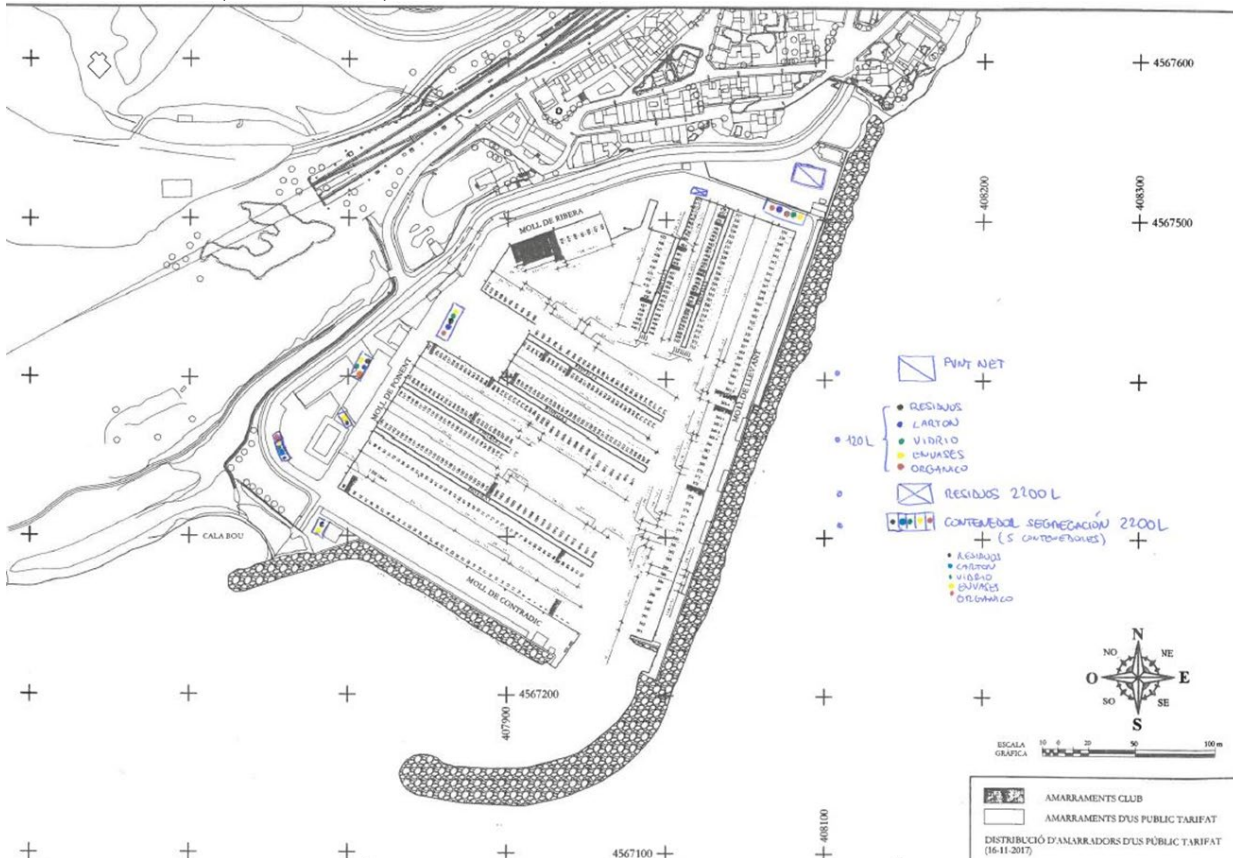

Dry dock opening hours for picking up the keys to the Clean Point:

Monday to Friday	09:00 – 17:00 without interruption
<p>OUTSIDE THESE HOURS THE SAILOR ON DUTY WILL BE CALLED FROM 7:00 A.M. TO 10 P.M. PHONE SAILOR ON DUTY 609 749 212</p>	

List of waste collected at the port:

1. Used oils
1. Batteries
2. Contaminated metal containers
3. Contaminated plastic packaging
4. Fibers or fabrics of animal, vegetable or synthetic origin
5. Oil and fuel filters
6. Paint sludge and varnishes
7. Aqueous liquid waste containing hazardous substances
8. Dissolvents
9. Absorbents
10. Traces of paint
11. Non-halogenated sludge
12. Lamps, bulbs and fluorescent lights
13. Banal

14. Cardboard and paper, packaging, glass and organic
15. Iron
16. Wood

Contact points of installation managers

To contact those responsible for managing the waste generated by vessels based in the port or that call at the port, they should go to the shipyard. The contact telephone number is 93 632 00 13 and the email varador@clubnauticgarraf.com. The opening hours are as follows:

Monday to Friday	09:00 – 17:00 without interruption
OUTSIDE THESE HOURS THE SAILOR ON DUTY WILL BE CALLED FROM 07:00 A.M. TO 10 P.M. TLFN SAILOR ON DUTY 609 749 212	

Waste delivery procedure to port facilities

1. Clean point: ask for the key at the dry dock.
2. Hydrocarbon water: contact dry dock.
3. Bilge waters: contact dry dock.
4. Iron: make use of the specific container located in the dry dock area.
5. Banal: make use of the islands for collecting this type of waste.
6. Domestic: make use of the islands for collecting this type of waste.

Cost recovery

Direct costs		Indirect costs		Net income	
Clean point containers	945,16€	Ecogesa	€8,880.00		
Garbage bags	€1,200.00	AENOR	€4,016.60		
Waste tax	€102.85				
Pick-up Clean Point	€2,039.14				
TOTAL	4.287.155 €	TOTAL	12.896,60€	TOTAL	0 €